

Y STRAINER CAST IRON JIS 10K

ONDA
INDUSTRIAL VALVE

Fig. 10FCJ (Bronze mounted)
Fig. 10FCJS (13 Cr. mounted)
Fig. 10FCJU (18-8 mounted)

Bolted bonnet, Y-pattern body,
Punched stainless steel plate screen.

60°C WOG (12" & smaller).....14 kgf / cm²
60°C Water, oil, gas.....8.8 kgf / cm²
Saturated steam.....7 kgf / cm²
Hydrostatic shell test.....21 kgf / cm²



Flanged ends JIS B2210
F-F dimension ONDA Std.
Wall thickness ONDA Std.

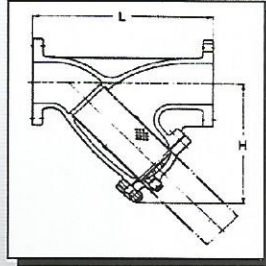

Materials

Parts	JIS materials
Body	FC20
Cap (Size 3/8" to 1-1/2")	C3771BE
Cover (2" & larger)	FC20
Gasket	Asbestos - free
Screen	SUS304
Cover bolt/nut	SS41
Plug	SUS304 (Size 1-1/2" to 3") C3771BD (Size 4" to 14")

Screen Dimensions

Valve Size	A	P	Thickness
5" or smaller	1.5 Ø	2.5 Ø	0.5 Ø
6" & 8"	3.0 Ø	5.0 Ø	1.0 Ø
10" & larger	5.0 Ø	7.0 Ø	1.0 Ø

Dimensions

Valve size	mm	50	65	80	100	125	150	200	250	300
	inch	2	2-1/2	3	4	5	6	8	10	12
L Face - to face		230	305	360	415	465	515	580	680	800
H Height		127	212	242	284	325	370	440	515	600

FLANGE 2 BELOWS JIS 10K (FLEXIBLE RUBBER JOINT)

ONDA
INDUSTRIAL VALVE

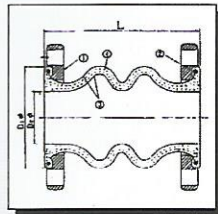

Materials

No.	Parts	JIS materials
1.	Flange	Mild Steel
2.	Reinforcing Ring	Carbon Steel
3.	Inner Rubber	Synthetic Rubber
4.	Outer Rubber	Synthetic Rubber

* Standard item employs JIS 10 kg/cm² flange. Maybe replaced with ANSI, BS, DIN, and other standard (drilling)

Nominal Dia.	Dimension [mm]	
	mm	inch
40	1-1/2	175
50	2	175
65	2-1/2	175
80	3	175
100	4	225
125	5	225
150	6	225
200	8	225

NEEDLE VALVE

ONDA
INDUSTRIAL VALVE

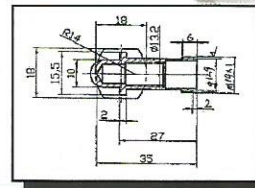
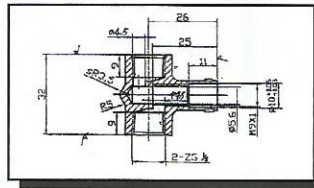

Material	Valve Type	End Connexion	Valve Class	Size Range (Inch)
Brass	Needle Valve	S.E	125 - 200	1/4 - 3/8