

# D900 S Curve LED surface



• Designed for high-end projects, the low-profile D900 S Curve is the slimmest directional surface-mounted downlight on the market. Offering a minimal aesthetic and unbeatable thermal performance, this ultra slimline design produces 900 lumens of Tru-Colour brightness.

|             |                               |  |   |  |
|-------------|-------------------------------|--|---|--|
| Electrical: | <b>Wattage:</b><br>12W        | <b>Efficacy:</b><br>60lm/W                             | <b>Dimming:</b><br>Triac (Digital Driver) | <b>Longevity:</b><br>L70 = 70,000 Hrs<br>L50 = 110,000 Hrs |
| Optical:    | <b>Lumen output:</b><br>900lm | <b>Colour temperature:</b><br>3000K (3K)<br>4000K (4K) | <b>Beam angle:</b><br>25°<br>40°          | <b>Tru-Colour:</b><br>Yes                                  |
| Physical:   | <b>Hole cutout:</b><br>20mm   | <b>Gimbal angle:</b><br>N/A                            | <b>Warranty:</b><br>7 years               | <b>IP rating:</b><br>IP44                                  |
|             | <b>Type:</b><br>Downlight     | <b>Body colour:</b><br>● White (W)<br>● Black (B)      | <b>Fascia colour:</b><br>N/A              | <b>Fascia style:</b><br>N/A                                |

## Photometrics:

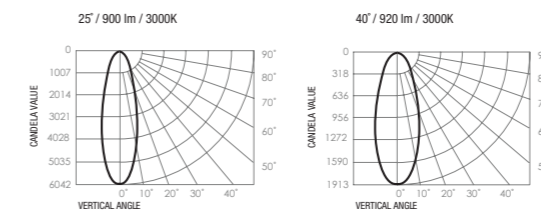

## Dimensions:

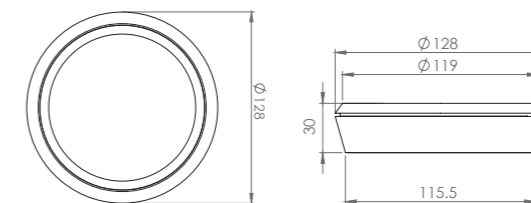

| Specifying product: | Product Name | Family | Colour Temp. | Beam Angle | Body Colour    | Eg. Product Code  |
|---------------------|--------------|--------|--------------|------------|----------------|-------------------|
|                     | D900.S       | CR     | 3K<br>4K     | 25°<br>40° | White<br>Black | D900.S-CR-3K-25-B |