

LEDTOUCH™ Cylinder Downlight Datasheet



LEDTOUCH™ Cylinder Downlight series is the ideal energy-saving replacement for 35W, 70W and 150W metal halide downlights, which provides high quality lighting for high-ceiling spaces for both indoor and outdoor applications. Intelligent control is available on request for better energy efficiency and operation efficiency.

Benefits

Energy saving

- 50% energy saving compared to metal halide downlight

Quality light

- Low glare ≤ 19
- No flicker light that uniformly distributed to create amicable environment

High reliability

- 50,000hrs lifetime ensured by OSRAM driver and well-design thermal dissipation
- Excellent mechanical design to ensure light weight and safety

Applications

- Train stations
- Airports
- Commercial buildings
- Shopping mall atria

LEDTOUCH™ Cylinder Downlight

Technical Data

Optical Specifications

		6"		8"	
Luminous Flux	3000K	1700 lm	3350 lm	3350 lm	6700 lm
	4000K	1800 lm	3600 lm	3600 lm	7200 lm
	*5700K	1900 lm	3840 lm	3840 lm	7200 lm
Efficacy	3000K	90 lm/W	90 lm/W	93 lm/W	93 lm/W
	4000K	95 lm/W	95 lm/W	100 lm/W	96 lm/W
	*5700K	100 lm/W	100 lm/W	106 lm/W	100 lm/W
CCT	3000K, 4000K, *5700K				
CRI	83				
SDCM	≤3				
UGR	≤19				
Beam Angle	30°, 60°		60°, 90°		

Electrical and Mechanical Specifications

Input Voltage	220-240V AC 50/60Hz			
Power Consumption	19W	36W	36W	75W
Power Factor	0.9			
Surge Protection	Line-to-line 1KV, line-to-ground 2KV			
Total Harmonic Distortion	<10%			
Dimensions (ØD × H)	150mm × 160mm (IP20) 150mm × 195mm (IP54)		220mm × 235mm (IP65)	
Weight	1.36kg (IP20) 1.8kg (IP54)		3.1kg	3.25kg
Cover Lens	Reflector		Lens	
Housing	Aluminium housing, white			

System Specifications

Power	AC line		
Dimmable	ON/OFF, *DALI		ON/OFF only
Installation	Suspended and ceiling mounting		
Operating Temperature	-20°C to +40°C		
Storage Temperature	-20°C to +80°C		
Environment	Indoor (IP20, IP54)		Outdoor (IP65)
Lumen Maintenance	L70 @25°C - 50,000hrs		
Safety Approval	Electrical Protection Class I, CB, CCC		

Items with * are non-standard items and are available on request. Specification is subject to change due to continuous improvement.

Due to the special conditions of manufacturing process of LED, the typical data of technical parameters can only reflect statistical figures and do not necessarily correspond to the actual parameters of each single product which could differ from typical data.

Exceeding maximum ratings for operation voltage will cause hazardous overload and will likely destroy the LED module.

Exceeding maximum ratings for operation and storage temperature will reduce expected life time or destroy the LED module.

11/16 V0.4 · Specifications are subject to change without notice. Errors and omission excepted, always make sure to use the most recent release.

LEDTOUCH™ Cylinder Downlight

Dimensions

6" (IP20)

6" (IP54)

8" (IP65)

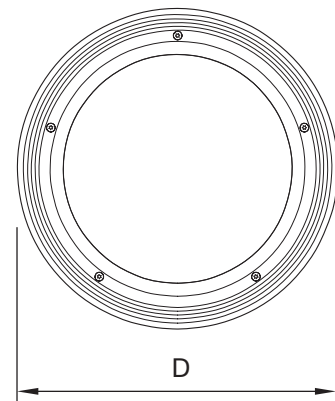
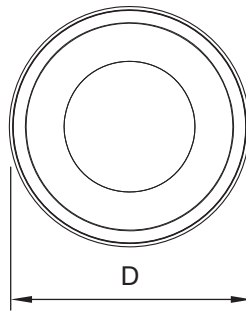
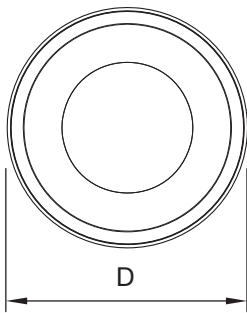
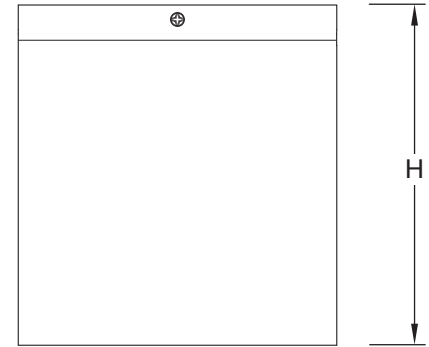
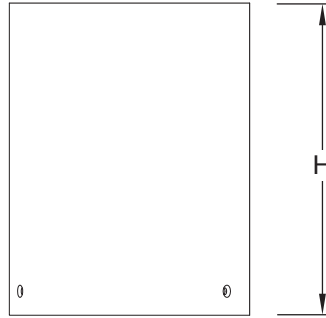
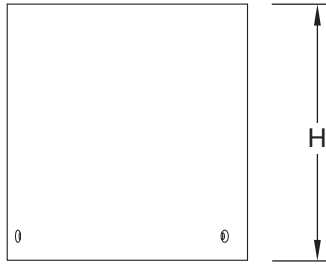

Dimensions

	6" (IP20)	6" (IP54)	8" (IP65)
D	150mm	150mm	220mm
H	160mm	195mm	235mm

LEDTOUCH™ Cylinder Downlight

Photometrics Light Distribution Curve

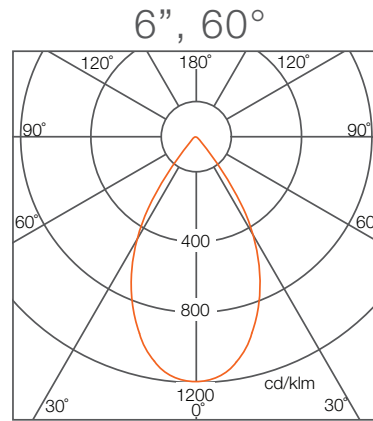
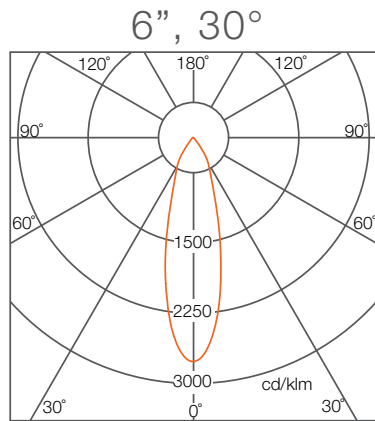

Illuminance at a distance

	Center Beam Lux/klm	Beam Width
0.5m	11440	0.25m
1m	2860	0.5m
1.5m	1271	0.75m
2m	715	1.0m
2.5m	458	1.25m
3m	318	1.5m

For feet multiply by 3.28

● Spread: 28.0°
For fc divide by 10.7

	Center Beam Lux/klm	Beam Width
0.5m	4780	0.56m
1m	1195	1.12m
1.5m	531	1.68m
2m	299	2.24m
2.5m	191	2.79m
3m	133	3.35m

For feet multiply by 3.28

● Spread: 58.4°
For fc divide by 10.7

Light Distribution Curve

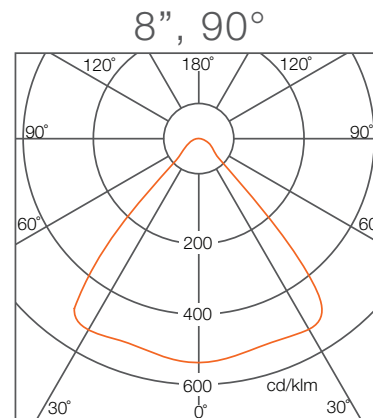
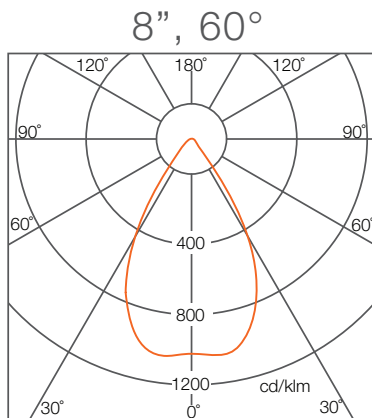

Illuminance at a distance

	Center Beam Lux/klm	Beam Width
0.5m	4650	0.53m
1m	1162	1.05m
1.5m	517	1.58m
2m	291	2.11m
2.5m	186	2.64m
3m	129	3.16m

For feet multiply by 3.28

● Spread: 55.6°
For fc divide by 10.7

	Center Beam Lux/klm	Beam Width
0.5m	2186	0.92m
1m	547	1.83m
1.5m	243	2.75m
2m	137	3.67m
2.5m	87	4.58m
3m	61	5.50m

For feet multiply by 3.28

● Spread: 85°
For fc divide by 10.7

Due to the manufacturing processes of LED, the polar candela distribution and distance luminaries only reflect statistical figures and do not necessarily correspond to the actual parameters of individual product that may differ from the typical values.

11/16 V0.4 · Specifications are subject to change without notice. Errors and omission excepted, always make sure to use the most recent release.

©2016 OSRAM GmbH · All rights reserved · Internet www.lightingsolutions.osram.com/asia

LEDTOUCH™ Cylinder Downlight

Ordering Codes

Fixture (IP20)

Short Text	Power	Beam Angle	CCT	Material	EAN10	EAN40
LDTH Cylinder 619 L30 830 20	19W	30°	3000K	AM007240055	4052899473713	4052899473720
LDTH Cylinder 619 L30 840 20	19W	30°	4000K	AM007250055	4052899473737	4052899473744
LDTH Cylinder 619 L60 830 20	19W	60°	3000K	AM007260055	4052899473751	4052899473768
LDTH Cylinder 619 L60 840 20	19W	60°	4000K	AM007270055	4052899473775	4052899473782
LDTH Cylinder 636 L30 830 20	36W	30°	3000K	AM007390055	4052899473799	4052899473805
LDTH Cylinder 636 L30 840 20	36W	30°	4000K	AM007280055	4052899473812	4052899473829
LDTH Cylinder 636 L60 830 20	36W	60°	3000K	AM007290055	4052899473836	4052899473843
LDTH Cylinder 636 L60 840 20	36W	60°	4000K	AM007300055	4052899473850	4052899473867

Fixture (IP54)

Short Text	Power	Beam Angle	CCT	Material	EAN10	EAN40
LDTH Cylinder 619 L30 830 54	19W	30°	3000K	AM015680055	4052899474048	4052899474055
LDTH Cylinder 619 L30 840 54	19W	30°	4000K	AM015690055	4052899474062	4052899474079
LDTH Cylinder 619 L60 830 54	19W	60°	3000K	AM015700055	4052899474086	4052899474093
LDTH Cylinder 619 L60 840 54	19W	60°	4000K	AM015710055	4052899474109	4052899474116
LDTH Cylinder 636 L30 830 54	36W	30°	3000K	AM015720055	4052899474123	4052899474130
LDTH Cylinder 636 L30 840 54	36W	30°	4000K	AM015730055	4052899474147	4052899474154
LDTH Cylinder 636 L60 830 54	36W	60°	3000K	AM015740055	4052899474161	4052899474178
LDTH Cylinder 636 L60 840 54	36W	60°	4000K	AM015750055	4052899474185	4052899474192

Fixture (IP65)

Short Text	Power	Beam Angle	CCT	Material	EAN10	EAN40
LDTH Cylinder 836 L60 830 65	36W	60°	3000K	AM007310055	4052899473874	4052899473881
LDTH Cylinder 836 L60 840 65	36W	60°	4000K	AM007320055	4052899473898	4052899473904
LDTH Cylinder 836 L90 830 65	36W	90°	3000K	AM007330055	4052899473911	4052899473928
LDTH Cylinder 836 L90 840 65	36W	90°	4000K	AM007340055	4052899473935	4052899473942
LDTH Cylinder 875 L60 830 65	75W	60°	3000K	AM007350055	4052899473966	4052899473973
LDTH Cylinder 875 L60 840 65	75W	60°	4000K	AM007360055	4052899473980	4052899473997
LDTH Cylinder 875 L90 830 65	75W	90°	3000K	AM007370055	4052899474000	4052899474017
LDTH Cylinder 875 L90 840 65	75W	90°	4000K	AM007380055	4052899474024	4052899474031

Due to the manufacturing processes of LED, the polar candela distribution and distance luminaries only reflect statistical figures and do not necessarily correspond to the actual parameters of individual product that may differ from the typical values.

11/16 V0.4 · Specifications are subject to change without notice. Errors and omission excepted, always make sure to use the most recent release.