

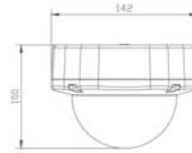

H.264 IP 2 MEGA PIXEL CMOS 3-AXIS VANDAL DOME ON-HO96(w/o IR) / ON-Hi96R(w/IR)

Features:

- 2 Mega pixel (1600 x 1200)
- H.264/MPEG-4/JPEG triple streams simultaneously
- Up to 32G SD card recording for alarm trigger & network outage
- 3-Axis design with vandal proof & IP 66
- Varifocal auto iris lens
- Optical IR cut removal (ICR) built in
- 2-way audio
- Mobile view support
- PoE support



ON-Hi96R

Server	Network Compression	Triple streams:H.264/MPEG-4/JPEG
	Pixel (H x V)	1600x1200, 1280x1024, 1280x960, 1280x720, 800x592,640x480, 320x240, 176x144
	Traffic Control	32/48/64/96/128/196/256/320/384/448/512/576/640/704/768K bps 1/1.5/2/2.5/3/3.5/4/6/8Mbps
	Max. Frame Rate	Max. 30FPS (1280x720, 800x592, 640x480, 320x240,176x144), 25FPS (1280x960), 22FPS (1280x1024), 15FPS (1600x1200)
	Safety	User-ID and password
	Protocol	TCP, UDP, IP, HTTP, FTP, SMTP, DHCP, PPPoE, DNS, DDNS, NTP, UPnP, UPnP forwarding, RTSP
	Number of User	Max. 10 connections for singal video
	Storage Capacity	SD card
	Alerting	SMTP, FTP, HTTP, SD card
	Pre / Post Alarm	Pre (0,1,2,3,4,5), post(0,1,2,3,4,5,10) seconds
Network Camera	Release for alarm	Motion detection, I/O or schedule
	Image Pick-up Device	1/3" Progressive Scan CMOS sensor, approximately 2 mega pixel
	BLC	Auto (ON/OFF)
	Electronic Shutter	1/50 (1/60) ~ 1/100,000 second
	Video Output	1Vp-p, 75 Ohms
	Min Illum.	0.1 - 100.000 Lux (in night color mode 0.01-100.000 Lux)
	Lens	2.7-9mm auto iris for ON-Hi96R / 2.7-9mm manual iris for ON-HO96
	Optical	IR cut filter for ON-Hi96R
	IR LED / Range	ON-Hi96R: 18 units IR LED for 15 M
	Audio Communication	2-way-halfduplex
Audio	Audio Compression	ADPCM 32Kbps
	Frequency	300 Hz - 3.4KHz
	Audio In	Connecting base, line in for microphone
	Audio Out	Connecting base, line out for external speaker
Terminal	Network Interface	Ethernet(10Base-T/100Base-Tx)
	Video Interface	Connecting base, Video composi (NTSC/PAL)
	External Port	Alarm-in x1 / relay-out x1
	SD Card	SD memory card with the 32GB, 16GB, 8GB, 4GB~64MB
General	Operation Voltage	PoE: 48V, IEEE 802.3af for option (max. 7W) LAN: 12V DC (max. 6W)
	Dimen./Weight	142(H)x142(W)x100(D)mm / @1,000g / 12pcs per carton
	Operation Temp.	-10° ~ +45°, relative moisture 20%-90%
	Waterproof	IP66



ON-HO96



Vandal dome is with 3-axis mechanism, which you can

Order Reference

ON-HO96P: PoE \ ON-Hi96R: IR/ICR \ ON-Hi96RP: IR/ICR/PoE