

Item || Split Core Current Transformer Model || E-CT500-SC36

Dimension (Unit:mm)

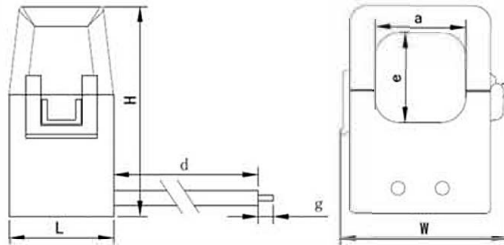

Outline Size			Window Size		Installation Size	
L	W	H	a	e	d	g
42	68	85	36	37	1000	6

Electrical Diagram Parameters



Rated Current	500A
Output	333mV
Accuracy	1.0
Frequency	50/60HZ
Insulation Strength	3KV

Performance Curve Specification

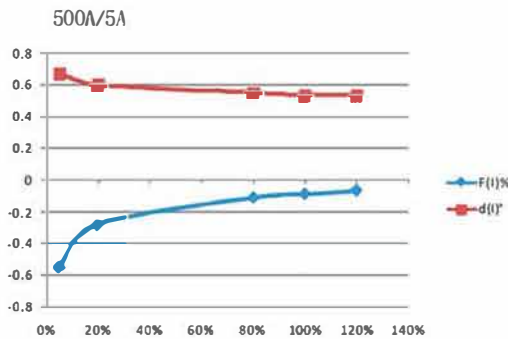

Leads:12AWG  
 Operating Temperature:-20°C to +55°C  
 Storage Temperature:-40°C to +70°C  
 Features: Split core design, The split core design permits non-contact current measurements through magnetic field induction without requiring that the primary wire be taken offline and disconnected for CT installation. This method permits a safer, easy and portable current measurement.