

JF Series

Features

- Since these products operate regardless liquid resistance, these products are optimum for control the level of liquids such as clean water, waste water, saline solution, milk, heavy oil, diesel, cooking oil, etc.
- Not affected by the capacitance between external lead wires and can be operated remotely.
- Can be installed outdoors because a water proof main body cover is employed.
- Floats for organic solvents such as gasoline, heavy oil, benzene, and alcohol can be manufactured
- Can be used for single phase and three phase

Specifications

Item	JF-32	JF-302T
Rated contact point capacity	AC250V 10A	
Frequency	50/60Hz	
Usable control range	0.18~10M	
Air pressure in the water tank	1 Atmosphere	
Usable temperature range	0~50°C	0~120°C
Rod material	Resin	STS 304
Scope of applicable fluids	Clean water, waste water, saline solution, corrosive liquids	Milk, heavy oil, diesel, cooking oil, benzene, alcohol, etc.



Dimensions

Unit: mm

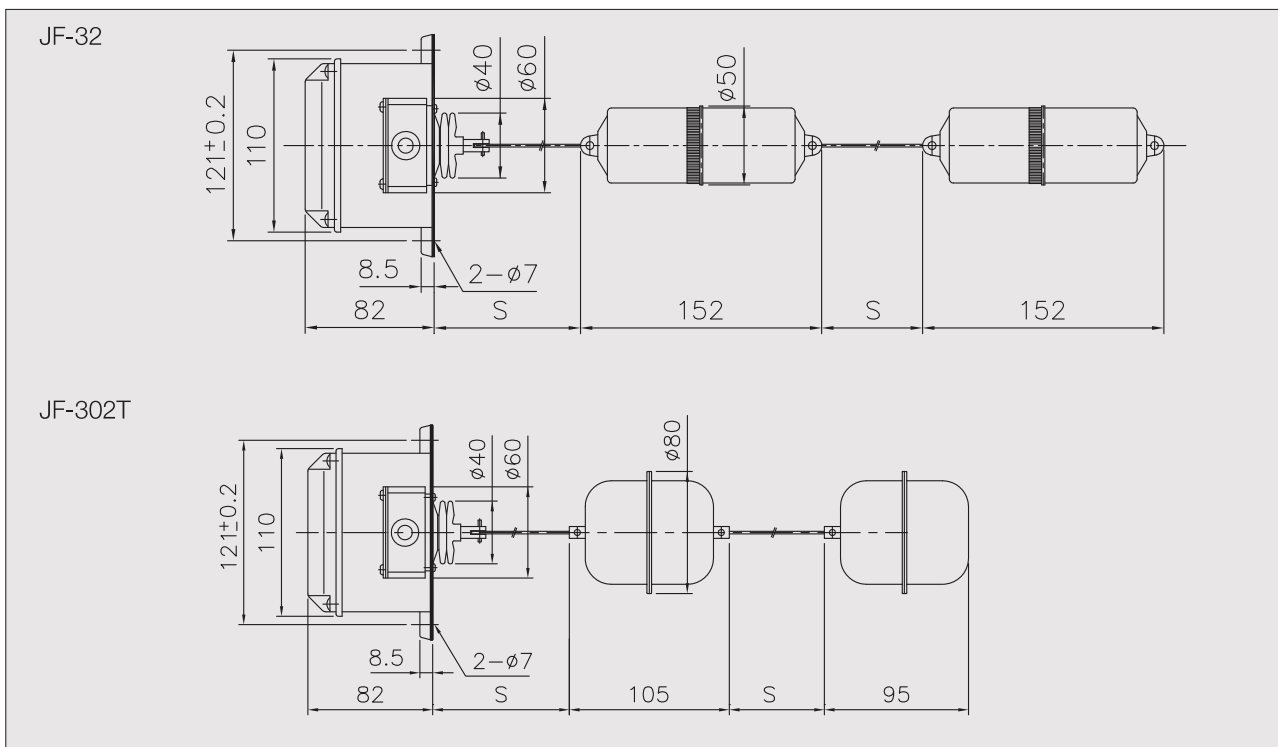

Liquid specific gravity table

Water	1.0
Sea water	1.01~1.05
Diesel	0.83~0.88
Heavy oil	0.85~0.9

Contact point rated capacity

JF32-JF-302T

AC110~125V	10A
AC220~250V	10A
AC440~480V	3A
AC600V	2A

21FG

AC110~125V	5A
AC220~250V	4A

The above written rated capacities are values for resistive loads ($\cos \phi \approx 1$). In the case of inductive loads, the rated capacities may be regarded as 1/2 of the above written values.

How to use and matters to be attended

External connection diagram (water supply/three phase)

- When using for water drainage, use terminal B instead of terminal A.
- Ensure that the float would not be shaken by water flows or impacts
- This is suitable for level control that operates regardless of drained liquids' resistance
- Not affected by external induction or capacitance between wires and easily operated remotely.

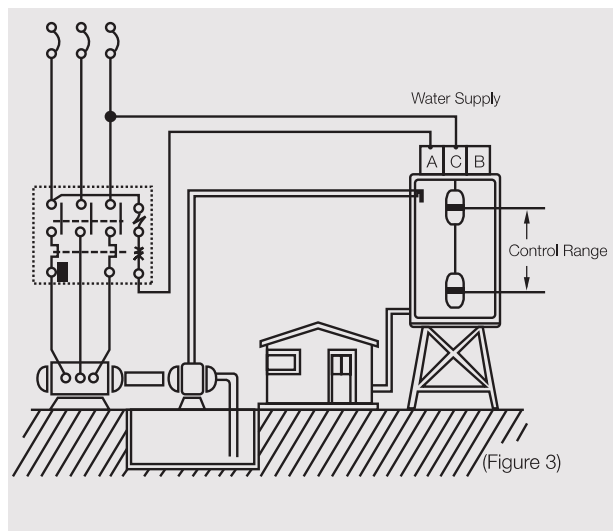

Diagram of connection for pump idling prevention, alarms, and water supply control

- Please use JF-32 type floats at temperatures not exceeding 50°C because they are made of synthetic resins. Use JF-302T floats made of a stainless steel rod for high temperatures

