

Crosby® Connecting Links



A-336



- Forged Alloy Steel - Quenched and Tempered.
- Individually Proof Tested at 2-1/2 times the Working Load Limit with certification.
- Easy to assemble - see instructions on page 269.

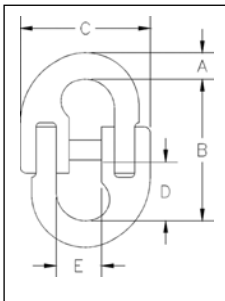

A-336 LOK-A-LOY® 6 Connecting Link

Chain Size (mm)	A-336 Stock No.	Working Load Limit (t)*	Weight Each (kg)	Dimensions (mm)					Diameter of Hole to Accept Link (mm)
				A	B	C	D	E	
6-7	1014397	1.47	.11	7.85	52.5	42.9	19.8	19.8	12.7
8-10	1014413	3.00	.27	11.4	69.0	58.5	26.9	27.7	16.8
13	1014431	5.10	.54	14.7	85.0	80.5	32.5	35.8	22.4
16	1014459	7.48	1.10	19.8	99.5	100	39.6	42.9	26.9
19	1014477	10.45	1.76	22.6	123	113	50.0	51.0	30.2
22	1014495	13.04	2.75	25.4	148	135	60.5	64.0	35.1
26	1014510	17.58	3.19	27.4	165	154	72.0	65.0	37.3
32	1014538	26.00	6.00	35.1	215	194	96.0	96.0	44.0

* Ultimate Load is 4 times the Working Load Limit.

The WLL of the A-336 are less than Grade 80 chain ratings. When using in Grade 80 chain slings, ANSI B30.9c requires that the Working Load Limit of a sling must not exceed the lowest Working Load Limit of the components in the system.