

HITACHI CHAIN

DIGEST

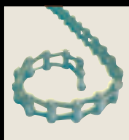
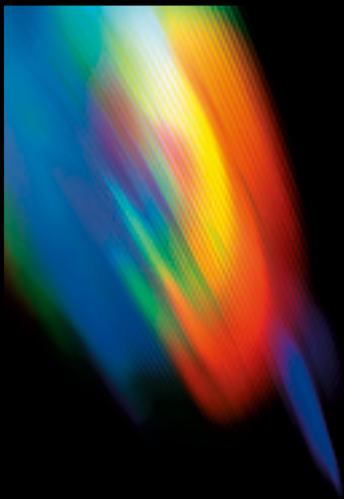

Why HITACHI CHAIN Products Are Excellent!

Hitachi Metals Techno, Ltd. is one of the world's top manufacturers of chains who has facilities from production of primary materials to manufacturing of finished products.

In 1910, we were the first Japanese company to manufacture malleable iron on a commercial basis, for our gourd brand chain. Malleable Iron's outstanding mechanical properties and resistance to corrosion and wear assure long life for chains. Thus, malleable iron chains with the gourd brand have an excellent reputation with users worldwide.

Hitachi Metals' Yasugi Works has studied the quality of Japanese Swords and employed new techniques, backed with the results of the above study, to produce the material for Hitachi Steel Chains. The material thus developed excels in toughness and wear-resistance, with our outstanding heat-treatment technologies.

Hitachi Metals Techno, has business partnership throughout the world, with only top class distributors, whose commitment to excellence is common.



CAUTION

For use of Hitachi Chain products, see our catalog or instruction manual.

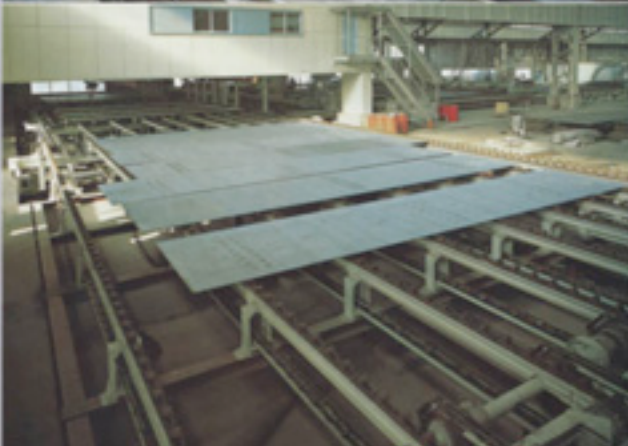

Roller Chain

1. Standard Roller Chain

Hitachi Roller Chains are made according to the specification requirements of ANSI/ISO. For European Countries, BS type roller chains are also available. ANSI/ISO/BS, any specification roller chains are available from stock and special attachments designed and made to order.



2. Double-Pitch Roller Chain (Conveyor series)

C2040-C2160H double-pitch roller chains with S rollers are assembled with the same diameter as those of power transmission chains No.40-No.160. C2042-C2162H have greater size rollers than height of linkplates.



•Double-pitch Roller Chain (Conveyor) S-type

•Double-pitch Roller Chain (Conveyor) R-type

3. Heavy Duty Engineering Chain

Heavy chain for earthworks and the construction of building foundations, power shovels, graders, excavators and other construction plant use heavy-duty roller chains which are able to stand up to wear and shocks.



4. Super Roller Chain

Super roller chains are developed for the greater resistance of fatigue and shock.



Conveyor Chain

1. Standard Conveyor Chain

HR and HRS conveyor chains are the basic types in the Hitachi Conveyor Chain product lines and consists of pins, bushings, rollers and link plates which are made of suitable materials combinations. R, F and S type rollers are available.

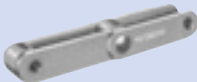

2. HB type Bushed Chain

HB chains are bushed chains without rollers, which are often used for trolley conveyor or log hole conveyor.

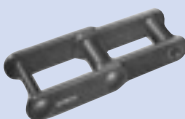

3. Steel Block Chain

Steel Block Chain is mainly used on line conveyors or transfer conveyors used to carry heavy finished or semi-finished products, and consists of plates pinned to blocks; for heavy loads in particular, one pitch is made up of a number of blocklinks, so the link plates are narrow, for more stability and smoothness.



4. Conveyor chain with attachments

Various types of attachments such as A, K, G attachment are available to match the requirements of the various applications. Attachments can be assembled at any required spacing.



•A attachment



•K attachment

Waste Water Treatment Plant Chain

1. SAV Stainless Steel Chain

SAV Stainless Steel Chain is a chain-saver type for sludge collectors, developed by our technology and years of experience in this field.



2. TAW Pintle Chain

TAW Pintle Chain is made from malleable iron to be used for sludge collectors with anti-abrasion and corrosion.



3. OSV Stainless Steel Chain

OSV Stainless Steel Chain is an offset type chain which was developed on HSS, SAV Stainless steel chain. OSV type can be exchanged with HSS and SAV type chains.



4 HEP Non-Metallic Chain

HEP Non-Metallic chains are high-grade engineering plastic chains especially made for sludge collectors, featuring light weight and corrosion resistance.



For other industries

1. Trolley Chain

Trolley chain is designed for flexible movement in every direction, in special design for connecting parts. Also, no lubrication is required under adverse environment. HT348C, HT458C are standard trolley chains. Corresponding hangers are also available.

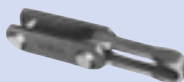

2. Side Roller Chain

Side Roller Chain is provided with rollers on one or both sides of the chain. The side rollers can be fitted either zigzag or parallel to one another, at any given interval. These side rollers ensure extremely stable chain travel.



3. Large size special purpose chain

Hitachi can meet every special purpose requirements, using large size chains, such as for tower parkings, wood-pulp grinder and so on.



4. Side Bow Chain

Pin-to-bushing clearance is much greater than in standard roller chains, and this, plus the clearances between inner and outer links, enables the chain to be used while bowed transversely.



Malleable Chain

1. Detachable Chain

Detachable Chain is used principally for light and medium loads, for driving conveyors or elevators at slow or intermediate speed. Simple to handle and economical, this is used extensively in almost all industries.



2. Pintle Chain

Pintle chain is used for many purposes, since they are strong, have a long life and can be used at high speed.



3. Drag Chain

Drag chain is specially designed for heavy conveyors for transporting gritty material.

The barrels are long and serve as scrapers. The bottom of the chain is a wide wearing shoe.

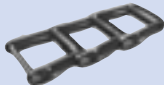

4. Combination Chain

Combination chain essentially consists of a cast block link and steel side bar jointed into a couple with a steel pin. A variety of attachments and size is available. Both block link and link plates are made of alloy steel for water treatment plant use.



For special applications

1. O-ring Chain

O-ring chain requires no lubrication because of grease oil applied between pin and bushing, making possible to ten-fold increase in the chain life. This is suitable for use in adverse environments such as water, wastewater, dust, etc. Maintenance is scarcely necessary.



2. Stainless Steel Roller Chain

Stainless steel roller chain is manufactured of class 300 stainless steel to JIS/ANSI/BS dimensional specifications. This chain is ideal for water, highly acidic or alkaline locations, or very high or low temperature where resistance to corrosion and heat is a requirement.



3. Corrosion Resistant Roller Chain

Corrosion Resistant Roller Chain is manufactured by applying nickel plating or molybdenum coating or bonding to JIS/ANSI standard roller chains and double-pitch roller chains. They provide superior corrosion resistance.



4. Hollow Pin Chain

Hollow pin chain provides unlimited conveyor versatility, allowing easy insertion of cross rods or attachments to preassembled chain at desired spacing.

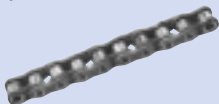

For special applications

5. Welded Chain

The chain is of welded steel, which has almost same dimensions as the malleable chain with same chain number fundamentally. The barrel is welded to the link plate.



6. Barn-Cleaner Chain

Barn-Cleaner Chain plays a vital part in improving the efficiency of mucking-out operations in cow-sheds, etc. These chains have high lateral flexibility and good resistance to corrosion and wear.



7. Case Conveyor Chain

Hitachi Case Conveyor Chain is classified forged type, steel type and cast type, which depends on materials to be conveyed. The standardized attachments are available, such as T, U, UA, UB, UC type.



Sprockets and accessories

1. Sprocket wheel

A variety kinds of sprocket wheels are available, such as sprocket wheels for power transmission roller chains, malleable chains and conveyor chains. The chains are driven smoothly with little wear and with small power consumption due to Hitachi Sprocket Wheel with utmost precision in dimension and high resistance to abrasion.



2. Snap Idle

Snap Idle has completely different structure from conventional chain tensioner in its feature of easy set-up and maintenance.



3. Chain Coupling

Chain Coupling consists of power transmission roller chains and sprocket wheel. Casing is made of special aluminium with resistance to rapid rolling and oil spill.



Product line

Roller chains

- Transmission roller chains
- Stainless steel roller chains
- Transmission double pitch roller chains
- Roller chains with special attachments
- Heavy-duty chains

Special chains

- Corrosion-resistant roller chains
- Roller chains with special attachments
- Curving travel-motion side bow chains
- O-ring chains

Conveyor chains

- Bushed roller chains
- Bushed chains
- Double-pitch roller chains for conveyors
- Case conveyor chains
- Water treatment steel chains
- Block chains
- Main chains for parking buildings
- Trolley chains

Chain attachments

- Sprocket wheels
- Chain couplings

Malleable chains

- Detachable chains
- Pintle chains
- Water treatment chains
- Drag chains
- Combination chains
- Malleable roller chains
- Cast steel chains

Works

- Chain related repair works

Building materials

- Access floor
- Steel structure bonding materials

If selecting, handling or maintenance of chains and sprockets, etc. is improper or insufficient, this can lead to major problems such as rupture or breakage. If there are any points you are unclear on, please consult the distributor where you obtained the products or this company. The contents of this catalog are subject to change without notice.

 **Hitachi Metals Techno, Ltd.**
<http://www.hitachi-metals-techno.com/>

Head Office Shingu Building 4-2, Toyo 2-chome, Koto-ku, Tokyo
135-8363, Japan
Phone: +81-3-3615-5421
Facsimile No.: +81-3-3615-5934

Kansai Office Nissay Shin-osaka Building, 4-30, Miyahara 3-chome
Yodogawa-ku, Osaka 532-0003, Japan
Phone: +81-6-6395-2125
Facsimile No.: +81-6-6395-2102