

**RUBBER D (DC) AND SQUIRE**

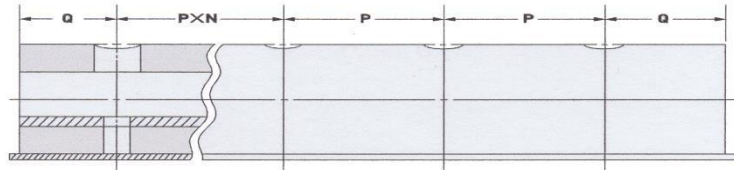

Vertical Fitting Bolt Method

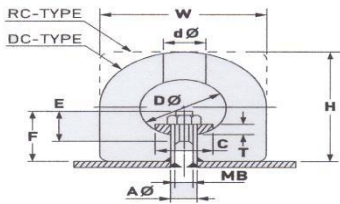

Cross Fitting Bolt Method

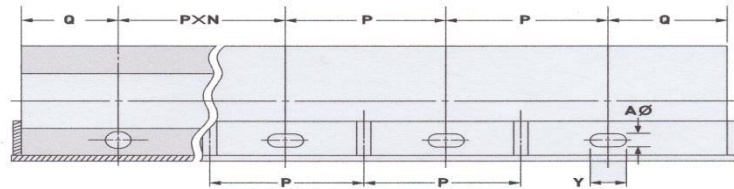
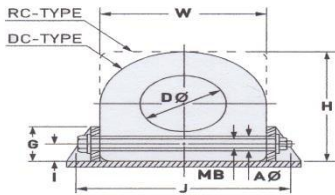

● RC, DC-Type Fender Dimension

(Unit:mm)

Size		DC 150H×75Ø	DC 200H×100Ø	DC 250H×125Ø	DC 300H×150Ø	DC 400H×200Ø	DC 500H×250Ø
Fender	DØ	75	100	125	150	200	250
	dØ	60	65	70	80	90	100
	C	50	65	80	90	100	120
	G	60	75	100	125	150	175
	H	150	200	250	300	400	500
	I	26	35	43	52	70	88
	J	220	280	350	400	520	640
	T	16	19	22	25	28	32
Frame	W	150	200	250	300	400	500
	AØ	22	25	28	32	36	42
	MB	M20 (3/4)	M22 (7/8)	M24 (1)	M27 (1 1/8)	M30 (1 1/4)	M36 (1 1/2)
	E	40	50	60	70	80	90
	F	80	95	112	132	180	210
	Y	32	38	42	48	54	62
	P	250 ~ 350					
Q	150 ~ 200						

● RC, DC Type Fender Performance Table

(1m Length)

Size		150H×75Ø	200H×100Ø	250H×125Ø	300H×150Ø	400H×200Ø	500H×250Ø
DC-Type	R·F(ton)	10.50	14.00	17.50	21.00	28.00	35.00
	E·A(ton-m)	0.29	0.52	0.80	1.16	2.06	3.22
RC-Type	R·F(ton)	16.80	22.40	28.00	33.60	44.80	56.00
	E·A(ton-m)	0.53	0.94	1.47	2.12	3.77	5.89

- R·F : Reaction Force(ton) - E·A : Energy Absorption(ton-m) - Tolerance : ±10% - Deflection : 50%