

CDM932NG-Pro WHEEL LOADER

Powerful QUANCHAI Engine
Reliable Powertrain

Hydraulic Transmission & Torque Converter
Variety with Attachment
Convenient Maintenance



- **RATED POWER:** 60kW/2400rpm
- **BUCKET CAPACITY:** 1.0m³
- **RATED PAYLOAD:** 1600kg
- **OPERATING WEIGHT:** 5500kg

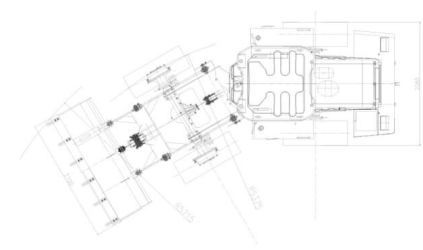
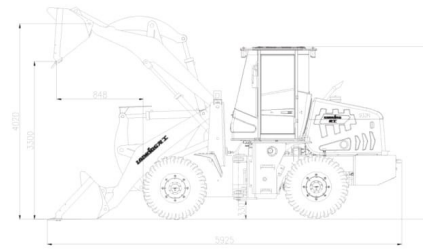

Overall Data	
Bucket Capacity (m ³)	1.0
Rated Payload (kg)	1600
Operating Weight (kg)	5500
Traction Force (kN)	52
Breakout Force (kN)	35
L×W×H (mm)	5925x2130x2950

Travel speeds (km/h):		
	I	II
Forward	8	20
Reverse	8	20

Engine		QUANCHAI4C5-82U31
Rated Power (kW /rpm)		60/2400
Rated Torque (Nm/rpm)		300/1600-1800
Starting Voltage (V)		24

Drive Train	
Torque Converter	Single-stage, Single-turbine, 3-element
Torque Ratio	3.13
Transmission	Fixed Shaft Hydraulic Shift Spur Gear
Gear	2F/2R
Pressure of Transmission (MPa)	1.1-1.5
Main Reducer	Spiral Bevel Gear Single-stage Reduction
Final Reducer	Planetary Reduction
Tire	16/70-20

Service Brake	Air Drive, Four Wheel Brake (Dry)
Setting Pressure (MPa)	0.78
Parking & Emergency Brake	Flexible Shaft Controlled Caliper

Standard	Optional
Hydraulic Transmission	Log Grapple (J)
Dry Brake Drive Axle	Light-duty Grapple (ZZ)
Standard Bucket	High Dumping(G)
Mechanical Flexible Shaft Control	Enlarged Bucket (N)

Steering System	
Type	Hydraulic Load Sensor System
Cylinders-bore x Stroke (mm)	2-63X230
Steering Pump	Shared With Working Pump
System Pressure (MPa)	14
Steering Angle	±30°

Hydraulic System	
Lift Cylinders-bore x Stroke (mm)	2-90X775
Tilt Cylinder-bore x Stroke(mm)	1-90X452
Working Pump	Gear Pump
Flow Rate (L/min/rpm)	150/2400
System Pressure (MPa)	16

Hydraulic Cycle Time, Rated Load in Bucket (In Second):			
Raise (Loaded)	Dump	Lower (Empty)	Total
4.4	0.7	3.1	8.2

Electrical System	
System Voltage (V)	24
Battery (2 in series) (Ah)	160
Lamp Voltage (V)	24

Service Refill Capacity	
Fuel Tank (L)	90
Hydraulic Tank (L)	80
Transmission (L)	19
Front Axle (L) / Rear Axle (L)	24

Air Conditioning System (Optional)	
Heating Capacity (W)	4500(±10%)
Cooling Capacity (W)	3200(±10%)



PT. MITRA TEKNINDO SEJATI

Jakarta

Rukan Sedayu Square Blok D/08,
Cengkareng, Jakarta Barat - DKI
Jakarta.

Tangerang

Pergudangan Bizlink Citra Raya
Blok P5 No. 31 Jl. Pemda Tigaraksa
Kel. Sukamulya Kec. Cikupa Kab.
Tangerang - Banten.

Surabaya

Jl. Gunungsari No. 55-59 (gudang B)
Surabaya - Jawa Timur.

Makassar

Ruko Insingnia Blok B No. 17 Jl.
Perintis Kemerdekaan KM 15 Kel.
Pai Kec. Biringkanaya Kota
Makassar - Sulawesi Selatan.