

Professional II Series (1P/1P)-Tower

PRO900-WS/WL SERIES

PROLiNK Professional II Series (1P/1P) is a single-phase UPS system using microprocessor controlled true online double conversion technology and it can be used to provide protection for critical loads especially on IT applications. High input power factor correction in the system improves efficiency and reduces overall losses.

Users can easily monitor and access to their UPS status from a comprehensive LCD display. Both Tower and Rack Types of UPS systems have USB and RS-232 communication ports as standard, with a built-in intelligent slot for additional adapters, protocol converters and relay contact cards. SNMP option is also available for power management via SNMP manager and web browser.

In addition, Emergency Power Off (EPO) function is also available to protect the personnel and the equipment in case of fire outbreak or other types of emergency.



CCTV & Security
Systems



Local Area
Network (LAN)



Work-Stations



Servers



ATM

- **True double-conversion**
- **Microprocessor control optimizes reliability**
- **Input power factor correction**
- **Output power factor 0.8**
- **Wide input voltage (110 V – 300 V)**
- **Converter mode available**
- **ECO mode for energy saving (Only available for 1-3KVA model)**
- **Generator compatible**
- **Smart SNMP works well with either USB or RS-232 together**
- **Optional Emergency Power Off function [EPO]**

Rear Panel

1-3KVA

1. AC input
2. Input circuit breaker
3. USB communication port
4. RS-232 communication port

5. Intelligent slot
6. External battery connection (only available for L model)

7. Output receptacles
8. Output circuit breaker
9. Output terminal

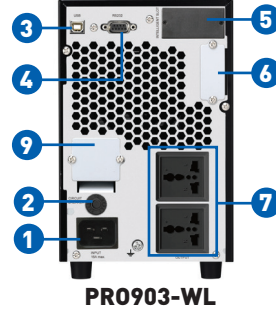
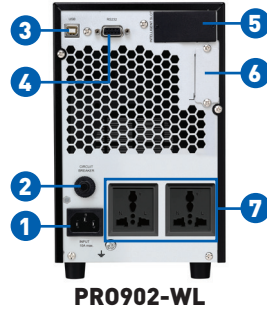
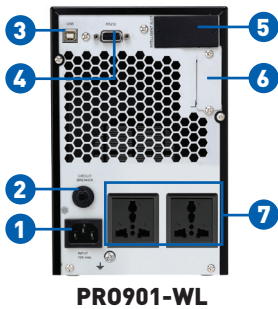
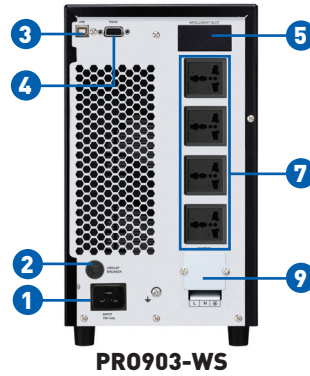
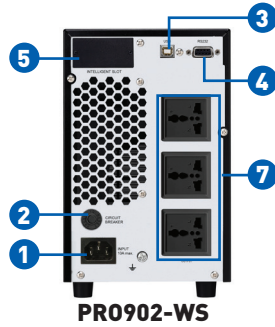
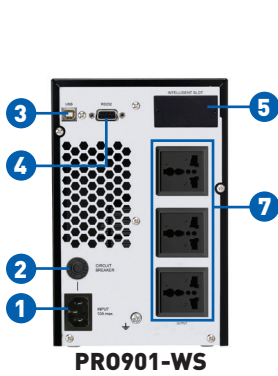

Note : IEC/NEMA/Schuko outlets options are also available.

Rear Panel

6-10KVA

1. External battery connector
2. RS-232 communication port
3. Intelligent slot
4. USB Communication port
5. Emergency power off function connector (EPO connector)
6. Cooling fan
7. Input circuit breaker
8. Input/Output terminal
9. Maintenance bypass switch (Optional)

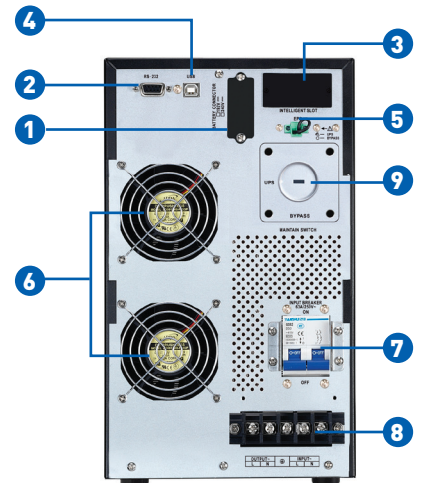

PR0906-WS / PR0910-WS

PR0906-WL / PR0910-WL



Full Specifications

MODEL		PRO901-WS/WL		PRO902-WS/WL		PRO903-WS/WL	
PHASE		Single phase with ground					
CAPACITY *		1000 VA / 800 W		2000 VA / 1600 W		3000 VA / 2400 W	
INPUT							
Nominal Voltage		200/208/220/230/240VAC					
Input Voltage Range		110-300 VAC (Based on load at 50%) 160-280VAC (Based on load at 100%)					
Frequency Range		40 Hz ~ 70 Hz					
Power Factor		≥ 0.99 @ Nominall Voltage (100% load)					
OUTPUT							
Output Voltage		200/208/220/230/240VAC					
Voltage Regulation		± 1 %					
Frequency Range (Synchronized Range)		47~ 53 Hz or 57 ~ 63 Hz					
Frequency Range (Batt. Mode)		50 Hz ± 0.25 Hz or 60Hz ± 0.3 Hz					
Current Crest Ratio		3:1					
Harmonic Distortion		≤ 3 % THD (Linear Load) ≤ 6 % THD (Non-linear Load)					
Transfer Time	AC Mode to Battery Mode	Zero					
	Inverter to Bypass	4 ms (Typical)					
Waveform (Batt. Mode)		Pure Sinewave					
EFFICIENCY							
AC Mode		88%		88%		90%	
Battery Mode		83%		87%		88%	
BATTERY							
Standard Model	Battery Type	12 V / 9 Ah		12 V / 9 Ah		12 V / 9 Ah	
	Numbers	2		4		6	
	Typical Recharge Time	4 hours recover to 90% capacity					
	Charging Current (max.)	1 A					
Long-run Model **	Charging Voltage	27.4VDC ± 1%		54.7 VDC ±1%		82.1 VDC ±1%	
	Battery Type	Depending on the capacity of external batteries					
	Numbers	2	3	4	6	8	6
	Charging Current (max.)	1A/2A/4A/6A (Adjustable)					
Long-run Model **	Charging Voltage	27.4 VDC ± 1%	41.0 VDC ± 1%	54.7 VDC ±1%	82.1 VDC ±1%	109.4 VDC ±1%	82.1 VDC ±1%
INDICATORS							
LCD		Load level, Battery level, AC mode, Battery mode, Bypass mode, and Fault indicators					
ALARM							
Battery Mode		Sounding every 4 seconds					
Low Battery		Sounding every second					
Overload		Sounding twice every second					
Fault		Continuously sounding					
PHYSICAL							
Standard Model	Dimension, DxWxH (mm)	282 x 145 x 220		397 x 145 x 220		421 x 190 x 318	
	Net Weight (kgs)	9.8		17		27.6	
Long-run Model **	Dimension, DxWxH (mm)	282 x 145 x 220		397 x 145 x 220			
	Net Weight (kgs)	4.1		6.8		7.4	
ENVIRONMENT							
Humidity		20-90 % RH @ 0- 40°C (Non-condensing)					
Noise Level		Less than 50dB @ 1 Meter					
MANAGEMENT							
Smart RS-232 / USB		Supports Windows® 2000/2003/XP/Vista/2008, Windows® 7/8/10, Linux and MAC					
Optional SNMP		Power management from SNMP manager and web browser					
COMPLIANCE STANDARDS							
Safety		IEC/EN 62040-1					
EMC		IEC/EN 62040-2					
Performance		IEC/EN 62040-3					

*1-3KVA: Derate to 80% of capacity in Frequency converter mode and to 80% when the output voltage is adjusted to 200/208VAC.

**Long-run model is only available for 200/208/220/230/240VAC systems.

Product specifications are subject to change without further notice.

100/110/115/120/127VAC input and output is available as an option for 1~3KVA



Full Specifications

MODEL		PRO906-WS/WL	PRO910-WS/WL	
PHASE		Single phase with ground		
CAPACITY *		6000VA / 4800W		10000 VA / 8000 W
INPUT				
Nominal Voltage		208/220/230/240VAC		
Input Voltage Range		110-300 VAC (Based on load at 50%) 176-300 VAC (Based on load at 100%)		
Frequency Range		46~54 Hz or 56~64 Hz		
Power Factor		≥ 0.99 @ Nominall Voltage (100% load)		
OUTPUT				
Output Voltage		208/220/230/240VAC		
Voltage Regulation		± 1 %		
Frequency Range (Synchronized Range)		46~54 Hz or 56~64 Hz		
Frequency Range (Batt. Mode)		50 Hz or 60Hz ± 0.1 Hz		
Current Crest Ratio		3:1		
Harmonic Distortion		≤ 3 % THD (Linear Load) ≤ 5 % THD (Non-linear Load)		
Transfer Time	AC Mode to Battery Mode	Zero		
	Inverter to Bypass	Zero		
Waveform (Batt. Mode)		Pure Sinewave		
EFFICIENCY				
AC Mode		92%	93%	
Battery Mode		90%	91%	
BATTERY				
Standard Model	Battery Type	12 V / 9 Ah		
	Numbers	16		
	Typical Recharge Time	9 hours recover to 90% capacity		
	Charging Current (max.)	1 A / 2 A		
	Charging Voltage	218.4 VDC ±1%		
Long-run Model **	Battery Type	Depending on the capacity of external batteries		
	Numbers	16 ~ 20 (Adjustable)		
	Charging Current (max.)	1A/2A/4A/6A (Adjustable, 6A is only available for 16pcs batteries)		
	Charging Voltage	273 VDC ±1% (Based on 20pcs batteries)		
INDICATORS				
LCD		Load level, Battery level, AC mode, Battery mode, Bypass mode, and Fault indicators		
ALARM				
Battery Mode		Sounding every 4 seconds		
Low Battery		Sounding every second		
Overload		Sounding twice every second		
Fault		Continuously sounding		
PHYSICAL				
Standard Model	Dimension, DxWxH (mm)	369 x 190 x 688	442 x 190 x 688	
	Net Weight (kgs)	61	74	66 76
Long-run Model **	Dimension, DxWxH (mm)	369 x 190 x 318	442 x 190 x 318	
	Net Weight (kgs)	12	16	
ENVIRONMENT				
Humidity		0-95% RH @ 0-50°C (non-condensing)	0-95% RH @ 0-40°C (non-condensing)	
Noise Level		Less than 55dB @ 1 Meter	Less than 58dB @ 1 Meter	
MANAGEMENT				
Smart RS-232 / USB		Supports Windows® 2000/2003/XP/Vista/2008, Windows® 7/8/10, Linux and MAC		
Optional SNMP		Power management from SNMP manager and web browser		
COMPLIANCE STANDARDS				
Safety		IEC/EN 62040-1		
EMC		IEC/EN 62040-2		
Performance		IEC/EN 62040-3		

*1-3KVA: Derate to 80% of capacity in Frequency converter mode and to 80% when the output voltage is adjusted to 200/208VAC.
 6-10KVA: Derate to 60% of capacity in Frequency converter mode and to 90% when the output voltage is adjusted to 208VAC.
 Product specifications are subject to change without further notice.
 20 blocks battery option is available for 6/10kVA Standard models

Ver1.1_18.6.2020

Authorised Distributor/ Reseller:



System Requirements:
 Windows 7/8/10, Linux, Mac*
 *Support for Intel-based Mac only

PROLINK® is a trademark of Fida International (S) Pte Ltd and is manufactured under its authority. Microsoft®, Windows®, Windows® 7/8/10 are either registered trademarks or trademarks of Microsoft Corporation in the U.S. and/or other countries. Mac and the Mac logo are trademarks of Apple, Inc., registered in the U.S. and other countries. Linux penguin "Tux" created by Larry Ewing and The Gimp. Linux® is the registered trademark of Linus Torvalds. All other brands, products, services, logos and company names mentioned herein are trademarks of their respective owners. All specifications, designs and contents are subject to change without prior notice. Product images are for demonstration and may vary from actual products due to product enhancement. © Copyright 2020. PROLINK® All rights reserved.

